

Catino sopraiano | Countertop WashBasin
code: ISBA02
Designer: Danilo Fedeli

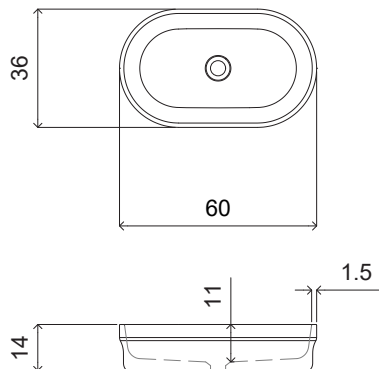

Materiali: NorahCrystal | NorahMarble
Materials: NorahCrystal | NorahMarble

Finiture NorahCrystal
Finish NorahCrystal



Finiture NorahMarble
Finish NorahMarble



Misure Size

Dimensioni cm <i>Dimension cm</i>	60x36x14
Peso netto Kg <i>Net weight Kg</i>	8,0 in NorahCrystal
Dimensioni imballo cm <i>Packaging dimension cm</i>	65x40x20
Peso lordo Kg <i>Gross weight Kg</i>	10,0 in NorahCrystal

Descrizione

Lavabo da appoggio ovale realizzato in NorahCrystal, disponibile in tutti i colori del nostro campionario. Disponibile in NorahMarble nelle nostre tre varianti. Completo di piletta scarico libero con tappo in finitura solid nero con logo NorahDesign.

Description

Oval countertop washbasin made of NorahCrystal, available in all colors from our sample range. Also available in NorahMarble in our three variants. Supplied with free-flow waste fitting and solid black finish cap featuring the NorahDesign logo.

Note

I lavabi realizzati nella versione Marmo non comprendono la cover con logo ma solo cover in finitura. Indicazioni prodotto per versione in Marmo
Peso netto Kg: 20,0 kg
Dimensioni imballo cm: 70x50x35
Peso lordo Kg: 25,0 kg

*Washbasins made in the Marble version do not include the logo cover, but come with a plain finish cover only. Product specifications for the Marble version:
Net weight: 45,0 kg
Packaging dimensions: 75 x 51 x 34 cm
Gross weight: 50,0 kg*

Dettaglio prodotto Product Details

CONFIGURAZIONE CONFIGURATION

